

THERMAL DYNAMICS *Professional*

1Torch[®]

with **SURELOK**[®] Technology



**One Torch
for Virtually Any
Plasma Cutting
System!**

Take the  **Challenge**

**30 Days, 100% Satisfaction
or Your Money Back,
Guaranteed!**

Call 1-800-752-7621 for details.

www.thermal-dynamics.com

**Available With Our ATC[®]
Quick Change Connector!**



The Revolution in Plasma Torches Has Begun

THERMAL DYNAMICS
Professional

1Torch®

with **SURELOK®** Technology



The First Universal Plasma Torch!

The 1Torch® RPT® torch is the first plasma cutting torch that performs with virtually all plasma cutting power supplies. The 1Torch works with high frequency start systems, CD start systems, touch start systems and moving parts (blow back) start systems. Install the 1Torch on your current plasma power supply and you immediately benefit from the latest in high performance torch technology available today.

Important Features Include:

Ergonomic Torch Handle

With an innovative, easy-to-use torch trigger release, encapsulated protected torch head and precisely engineered grip, the 1Torch RPT torch is both easy and comfortable to use.



Extended or Protected Consumable Parts

We designed our consumable parts to adapt to your cutting style. By simply changing the shield cup, you can either have:

- An Extended Tip for greater visibility and control and precision drag cutting at low power.
- A Protected Tip for on-the-plate drag cutting at high power up to 100 amps.

One Year Torch & Leads Warranty

Precision Engineered Torch Consumable Parts

The 1Torch RPT torch introduces a completely new tip technology. Plasma gas management is an integral part of the tip design. Each tip is uniquely tuned to optimize cut performance at its rated cutting current. The result is precision gas management, longer consumable parts life and better cut performance across the entire range of 1Torch tips.

Lower Consumable Parts Inventories and Costs

The less than 25 consumable parts used with the 1Torch RPT torch can replace over 575 different consumable parts used over a broad range of plasma systems.

Improved Leads

1Torch Leads are lightweight, extremely flexible and tough – the ideal combination of durability and ease of use.

ATC® (Advanced Torch Connector) Quick Disconnect Option

Our quick disconnect design brings extra flexibility to any plasma system.

Imagine being able to change out a damaged plasma cutting torch, easily convert from a hand to a machine torch operation, or simply put on a different size torch all in the matter of a few seconds and not have to use any tools to complete the task!



ATC Lead Extensions for Improved Versatility

You can add substantial flexibility and versatility to your cutting operations with the use of Lead Extensions. Quick Disconnect Lead Extensions, in 15 ft., 25 ft. and 50 ft. lengths, make it easy and efficient to add or subtract lead length according to the job requirements.

1Torch RPT torch and ATC connector are patent pending.

1Torch®

with SURELOK® Technology

One Torch for Virtually Any Plasma Cutting System!

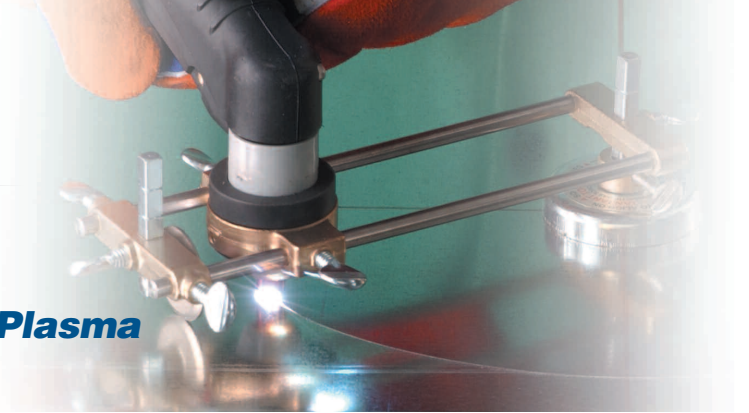

Selecting the Right Torch Package for Your Needs . . .

It's as easy as 1, 2, 3!

1 Torch and Leads Selection

Chart 1 (pg. 4) gives you all the information you'll need to select the right torch. Torches are grouped into two sections – SL60® and SL100® Hand Torches. Find the appropriate section, decide whether the standard RPT® connection or the ATC® Torch Connection is right for you, then select the torch with the desired amperage range and leads length.

2 Adapter Kit Selection

Select the appropriate Adapter Kit from Chart 2 (pg. 5). If you selected a torch with the ATC Connection, you will also need an ATC Receptacle Adapter (see Chart 1).

3 Spare Parts Selection

From Chart 3 (pg. 6), select an RPT Spare Parts Kit or specific consumable parts that best suit your cutting requirements.

Torch Connection Options

The diagram below shows the differences between the Standard RPT and the ATC Torch connections.

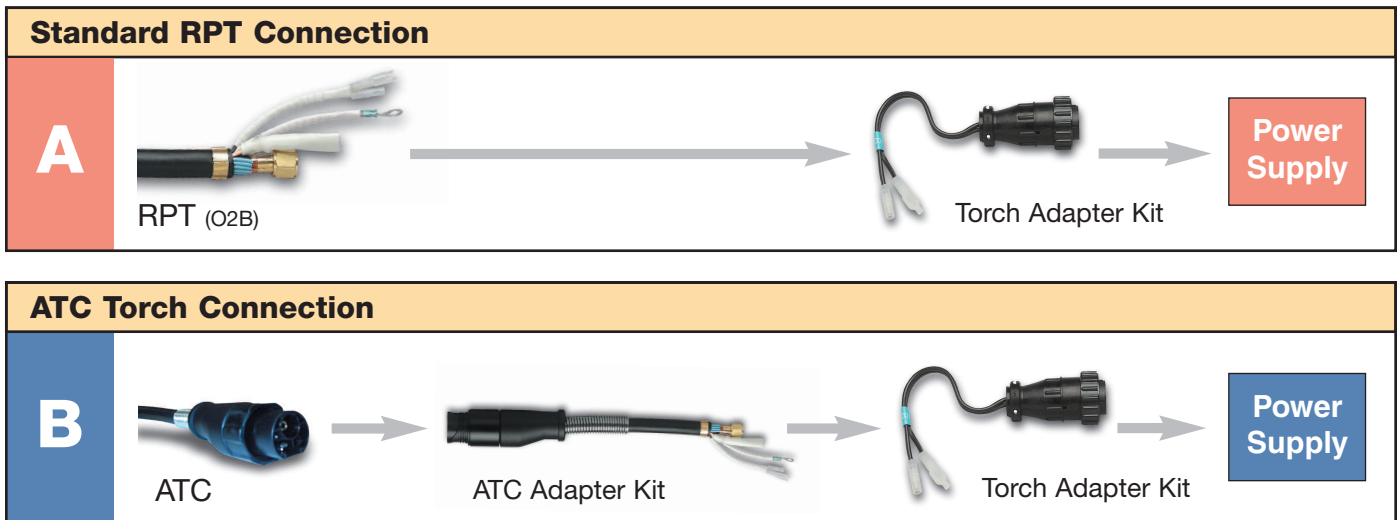

1Torch[®]
with **SURELOK**[®] Technology

Torch and Lead Selection

1

Listed below are the Torch and Lead selection charts for the SL60[®] and SL100[®] Hand 1Torch RPT[®] torches.

Ordering Information

Hand Torches

SL60

Light/Medium Duty Torch
20-60 Amps



SL100

Medium/Heavy Duty Torch
30-100 Amps



CAT NO. DESCRIPTION

A Standard RPT (O2B) Torch Connection

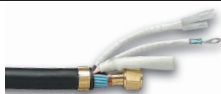

Torch & Leads

SL60 Hand Torch (20-60 Amps)	
7-5200	SL60, 75°, 20' (6.1m) Torch/Leads
7-5201	SL60, 75°, 50' (15.2m) Torch/Leads

B ATC[®] Torch Connection



Torch & Leads

SL60 Hand Torch w/ ATC (20-60 Amps)	
7-5204	*SL60, 75°, 20' (6.1m) Torch/Leads
7-5205	*SL60, 75°, 50' (15.2m) Torch/Leads

ATC Adapter Kit

ATC Receptacle Adapter	
7-5207	ATC Receptacle Connector

* This receptacle adapter is required for each power supply using an ATC torch connection. This is connected to the torch adapter kit specific to each power supply.



ATC Lead Extensions

Lead Extensions - Standard	
7-7544	15' (4.5m) Lead Extension
7-7545	25' (7.6m) Lead Extension
7-7552	50' (15.2m) Lead Extension

CAT NO. DESCRIPTION

A Standard RPT (O2B) Torch Connection



Torch & Leads

SL100 Hand Torch (30-100 Amps)	
7-5202	SL100, 75°, 20' (6.1m) Torch/Leads
7-5203	SL100, 75°, 50' (15.2m) Torch/Leads

B ATC Torch Connection



Torch & Leads

SL100 Hand Torch w/ ATC (30-100 Amps)	
7-5206	*SL100, 75°, 20' (6.1m) Torch/Leads
7-5208	*SL100, 75°, 50' (15.2m) Torch/Leads

ATC Adapter Kit

ATC Receptacle Adapter	
7-5207	ATC Receptacle Connector

* This receptacle adapter is required for each power supply using an ATC torch connection. This is connected to the torch adapter kit specific to each power supply.



ATC Lead Extensions

Lead Extensions - Standard	
7-7544	15' (4.5m) Lead Extension
7-7545	25' (7.6m) Lead Extension
7-7552	50' (15.2m) Lead Extension

NOTES: *Total lead length including torch and extension(s), should not exceed the maximum length specified by the power supply manufacturer.

1Torch®

with **SURELOK®** Technology

Adapter Kit Selection

Listed below is the Adapter Kit selection charts for the Hand 1Torch RPT torch.



Torch Adapter Kits

The model of the plasma cutting system must be known to determine the adapter kit required.

Manufacturer Power Supply Model	Catalog Number	Manufacturer Power Supply Model	Catalog Number
AIRCO®/BOC®		LINCOLN®	
PCS-43	7-3425	Pro-Cut® 40	7-3486
PCS-53, PCS-80, PCS-90	7-3435	Pro-Cut® 55	see 63-2530 for details
CEBORA®		Pro-Cut® 60	7-3431
50	7-3438	Pro-Cut® 80	see 63-2530 for details
Pocket 25	7-3476	MARQUETTE®	
CENTURY®		12/150, 12/200	7-3476
82020*, 82050*, M2050*	7-3476	MATCO®	
82100	7-3430	2020*, 2050*	7-3476
DAIHEN®		MILLER®	
SC-60P	7-3432	Plazcut 60†/Zipcut	7-3432
MRAT-70	7-3437	Spectrum® 250D, 500, 750	7-3433
DAYTON®		Spectrum® 700, 1000, 1250, PLUS	7-3430
3W722A*, 5Z031B*	7-3476	Spectrum® 3080*	7-3456
ESAB® (yellow)		Spectrum® 650*, 701*, 2050*	7-3457
PCM-SMi, 500i, 625i, PCS-43	7-3425	Spectrum® 300*	7-3476
PCS-53, 80, 90	7-3435	Spectrum® 375*	7-3477
ESP-100i	7-3426	Spectrum® 625*	7-3478
PCM-750i, 875, 1000i, 1125	7-3429	MULTIQUIP MQ®	
Sidewinder 30, 55, 105	7-3434	PCX50SS	7-3437
Powercut® 650	7-3464	NU-TECSYS®	
Powercut® 875, 1125	7-3465	Omnicut 375	7-3438
Powercut® 1250, 1500	7-3462	PCA-30/60, 65	7-3441
HARRIS®		OTC	
System 50, 65, 100	7-3439	Panasonic® D-5000, D-7000	7-3437
HOBART®		P-TRON®	
Smoothcut 30, 625	7-3425	P-Tron 75, 100	7-3437
Smoothcut 50 (single gas), 100	7-3426	POWCON®	
Smoothcut 50 (dual gas)	7-3428	Starcut	7-3430
Smoothcut II 35A, 60A, 100A	7-3427	SMITH®	
Fab Shop	7-3440	Powerpro 55, 75	7-3487
Cybercut 2050*	7-3457	SPC-30, 20-50, 40-80	7-3442
HYPERTHERM®		SNAP-ON®	
Max® 40, HT® 40 (H/F Start)	7-3430	YA-3230, YA-3440	7-3430
Max® 70, Max® 80, Max® 100 w/ & w/o Q.D.		YA-2230*, YA-5550*, YA-5550A*	7-3476
Max® 42*, 43*, 40cs*	7-3454	SOLAR®	
powermax® 600*, 800*, 900* w/ Q.D.		SOL 2020* (118-009, 118-010), SOL 2050* (118-015, 118-016)	7-3476
powermax® 1100*	7-3455	SOL 2105, SOL 2106	7-3430
powermax® 1000*, 1250*	7-3461	THERMAL DYNAMICS®	
Max® 40cs* (w/o Q.D.)	7-3476	PAK® 3XR, 5XT, 5XR, 6XR, 7XR, 625XR, 750XR	7-3446
powermax® 380*	7-3477	PAK® 8XR, 10XR, 1000XR, 1250XR,	7-3434
powermax® 600* w/o Q.D.	7-3480	PakMaster® 75, 100	
powermax® 800*, 900* w/o Q.D.	7-3481	PakMaster® 50XL/XLP, 75XL/XLP, 100XL/XLP	7-3447
powermax® 1650*	7-3483	CUTMASTER® 50, 75, 80XL, 100	
powermax® 350*	7-3484	PakMaster® 25, 38XL, EconoPAK® 25	7-3443
powermax® 190C*	7-3485	Drag-Gun® 38, PAK® 4Xi, 6Xi	
L TEC® (green)		PAK® 2XT, Dynapak® 110	
PCM-31, SMi, 32i/34i, VPi	7-3425	PakMaster® 50 w/ Smart Torch (Q.D.)	7-3445
PCM-500i, 625i, PCS-80i		EconoPAK® 50	7-3449
PCM-50A, 70, 80, 52i/54i, 82i/84i	7-3426	EconoPAK® 100	7-3450
ESP-100i, PCM-50, PCM-100 (Single Gas)		PAK® 5	7-3444
PCM-50, PCM-100 (Dual Gas)		PAK® 10	7-3436
PCS-40	7-3430		
PCM-750i, 1000i	7-3435		
PCM-101	7-3436		

*Non-HF Systems.

†The Miller PlazCut machines with Serial Numbers beginning JE are not compatible with 1Torch® RPT Torches.

NOTES: Each Adapter Kit includes connection fitting, electrical connectors and installation instruction sheets for the selected power supply.

AIRCO/BOC are registered trademarks of The BOC Group plc; CEBORA is a registered trademark of Cebora S.p.A.; DAIHEN is a registered trademark of Daihen Inc.; ESAB, L-TEC and Power-Cut are registered trademarks of ESAB AB; HARRIS, LINCOLN and Pro-Cut are registered trademarks of Lincoln Electric Co.; HOBART is a registered trademark of Hobart Brothers Co.; HYPERTHERM, Max and powermax are registered trademarks of Hypertherm, Inc.; MILLER and Spectrum are registered trademarks of Miller Electric Mfg. Co.; MULTIQUIP is a registered trademark of Multiquip, Inc.; NU-TEC-SYS is a registered trademark of Nu-Tecsys, Inc.; PANASONIC is a registered trademark of Matsushita Electric Industrial Co., Ltd.; P-TRON is a registered trademark of P-Tron Plasma/Tech Systems; SMITH is a registered trademark of Smith Equipment Co.; INNERLOGIC is a trademark of Innerlogic; none of the above mentioned registered trademarks are in any way affiliated with Thermal Dynamics or Thermadyne Industries, Inc.; THERMAL DYNAMICS, PAK, CUTMASTER, PakMaster, EconoPAK, Dynapak and Drag-Gun are registered trademarks of Thermal Dynamics Corp.



Ordering Information

Spare Parts Selection

Description	Cat. No.					
1Torch® Consumables / Parts						
O-Ring	8-3487	<p>SL60® / SL100® 1Torch Parts</p> <p>Patented SURELOK® U.S. Patent 6,163,008 Other Patents Pending</p> <p>8-3487 O-Ring 8-3486 O-Ring</p> <p>Electrode Start Cartridge</p> <p>Tip, Drag Shield Cup</p> <p>Tip, Cutting MaximumLife® Shield Cup Body</p> <p>Tip, Gouging Shield Cup</p> <p>MaximumLife® Shield Cup Body</p> <p>Drag Shield Cap</p> <p>Deflector Shield Cap</p> <p>Gouging Shield Cap</p>				
O-Ring	8-3486					
Electrode, MaximumLife®	9-8215					
Start Cartridge	9-8213					
Tip, 20A, Drag	9-8205					
Tip, 30A, Drag	9-8206					
Tip, 40A, Drag	9-8207					
Tip, 40A, Cutting	9-8208					
Tip, 50/55A, Cutting	9-8209					
Tip, 60A, Cutting	9-8210					
Tip, 70A, Cutting	9-8231					
Tip, 80A, Cutting	9-8211					
Tip, 90/100A, Cutting	9-8212					
Tip, A, Gouging	9-8225					
Tip, B, Gouging	9-8226					
Tip, C, Gouging	9-8227					
Tip, D, Gouging	9-8228					
Shield Cup	9-8218	Spare Parts Kit, 30 Amp	5-2550			
Shield Cup Body, MaximumLife®	9-8237	Spare Parts Kit, 40 Amp	5-2551			
Shield Cap, Drag, 40A	9-8244	Spare Parts Kit, 50/55 Amp	5-2552			
Shield Cap, Drag, 50-60A	9-8235	Spare Parts Kit, 60 Amp	5-2553			
Shield Cap, Drag, 70-100A	9-8236	Spare Parts Kit, 70 Amp	5-2554			
Shield Cap, Mach, 40A	9-8245	Spare Parts Kit, 80 Amp	5-2555			
Shield Cap, Mach, 50-60A	9-8238	Spare Parts Kit, 90/100 Amp	5-2556			
Shield Cap, Mach, 70-100A	9-8239					
Shield Cap, Deflector	9-8243					
Shield Cap, Gouging	9-8241					

(Note: All Spare Parts Kits include ten (10) Tips, five (5) Electrodes and one (1) Start Cartridge.)
 ■ Standard for all RPT® Torches ▲ Standard on SL60 RPT Torches ● Standard on SL100 RPT Torches

Product Description	Catalog No.	Product Description	Catalog No.	Product Description	Catalog No.
---------------------	-------------	---------------------	-------------	---------------------	-------------

Accessories

Single Stage Air Filter 7-7507

Leather Leads Cover

20 ft. (6.1m) 9-1260

25 ft. (7.6m) 9-1270

50 ft. (15.2m) 9-1280

Cutting Guide Kits

Circle Guide Kit 7-3291

Remote Pendant Control, 20 ft. (6.1m) 7-3460

For use with Machine Torch

Straight Line Cutting Guide 7-8911

Roller/Radius Kit 7-7501

Deluxe Kit 7-8910

1TORCH, ATC, RPT, SL60 and SL100, trademarks of Thermal Dynamics Corporation, are registered with the U.S. Patent and Trademark Office, and are the subject of trademark registrations and pending applications in numerous other countries. For information on trademark registrations of Thermal Dynamics Corporation, contact the local trademark offices in the countries of interest.

U.S. Plasma Manual Customer Care: 800-752-7621 / FAX 800-221-4401 • International Customer Care: 905-827-9777 / FAX 905-827-9797
U.S. Plasma Automation Customer Care: 866-279-2628 / FAX 316-941-4491 • www.thermal-dynamics.com



WORLD HEADQUARTERS: 16052 Swingley Ridge Road, Suite 300 • St. Louis, Missouri 63017 U.S.A.			
THE AMERICAS	EUROPE	ASIA/PACIFIC	
Denton, TX USA U.S. Customer Care Ph: (1) 800-752-7621 Fax: (1) 800-221-4401	Oakville, Ontario, Canada International Customer Care Ph: (1) 905-827-9777 Fax: (1) 905-827-9797	Cikarang, Indonesia Customer Care Ph: 62 21+ 8983-0011 / 0012 Fax: 62 21+ 893-6067	Melbourne, Australia Customer Care: Ph: 1300-654-674 Fax: 613- 9474-7391
West Lebanon, NH USA Customer Care, Plasma Ph: (1) 800-752-7621 Fax: (1) 800-221-4401	Miami, FL USA Sales Office, Latin America Ph: (1) 954-727-8371 Fax: (1) 954-727-8376	Milan, Italy Sales Office Ph: (39) 02-98-80320 Fax: (39) 02-98-281773	Rawang, Malaysia Customer Care Ph: 603+ 6092-2988 Fax: 603+ 6092-1085
	Rio de Janeiro, Brazil Customer Care Ph: (55) 21-2485-8998 Fax: (55) 21-2485-8866	Osaka, Japan Sales Office Ph: 816-4809-8411 Fax: 816-4809-8412	Shanghai, China Sales Office Ph: 86 21+ 6280-1273 Fax: 86 21+ 3226-0955
			Singapore Sales Office Ph: 65+ 6832-8066 Fax: 65+ 6763-5812